

NOTES:
 1 ALL DIMENSIONS SHOWN ARE FINISH OPERATIONAL DIMENSIONS WHICH INCLUDE RESIDUAL COATINGS UNLESS OTHERWISE SPECIFIED.

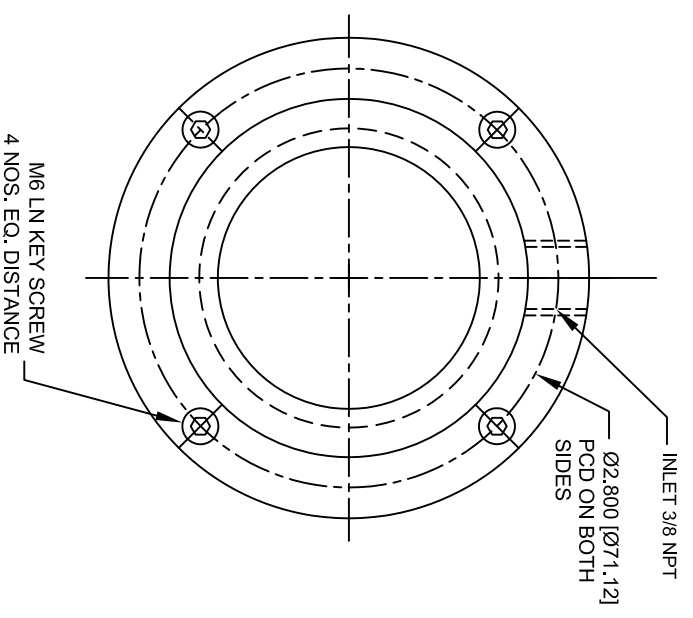
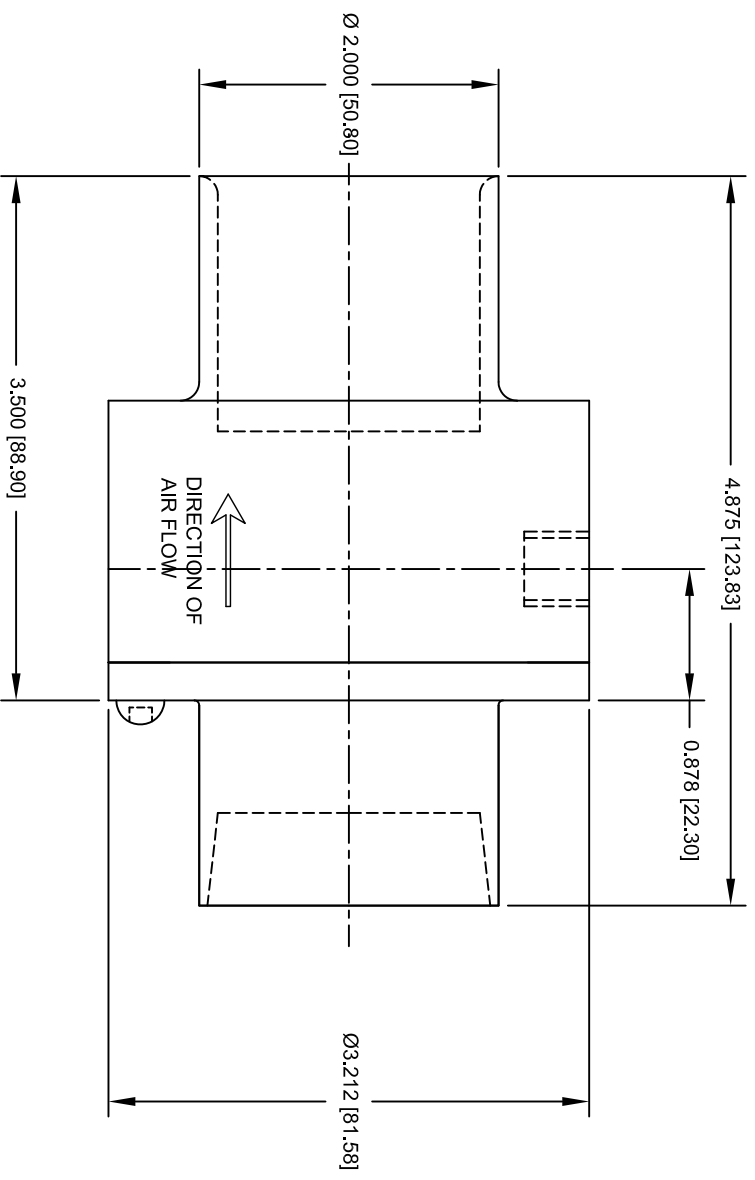

REV	DESCRIPTION	DATE	APPROVED

REVISIONS 1 2 3 4 5		REVISIONS 1 2 3 4 5		REVISIONS 1 2 3 4 5		REVISIONS 1 2 3 4 5		REVISIONS 1 2 3 4 5		REVISIONS 1 2 3 4 5							
REQUIREMENTS - FINISHES 1. DIMS ARE IN INCHES (UNLESS OTHERWISE SPECIFIED) 2. DIMENSIONS AND TOLERANCES ARE AS SHOWN 3. MACHINE FINISH 125 MICRO INCH RMS 4. INTERNAL RADIUS 0.15 5. BREAK SHARP CORNERS 200 TO 0.15 UNITS						CONTRACT NUMBER - CLIENT CONTRACTOR DATE 09-04-11 ORDER NO. ORDER PROJECT DCA						TITLE NEX FLOW AIR PRODUCTS CORP. 10520 YORK STREET, UNIT 259-220, RICHMOND HILL, ON L4C 3Y7 TEL: (416) 410-5115 & FAX: (416) 410-1605 WWW.NEX-FLOW.COM					
MATERIAL ALUMINIUM 6061 T6						FINISH THIRD ANGLE PROJECTION						FINISH THIRD ANGLE PROJECTION					
PART NO. NEXT ASSEMBLY USED ON PRT PART NO.						REVISIONS 1. LINE IN DIMS 2. ANGLES = 3 1/2° 3. MINIMUM 0.10 TH 4. HOLES IN ACCORDANCE WITH AND 10387						MANUFACTURING SIZE CODE CODE 300004 QTY NO 2-1 QTY NO 2-1-ALRV SHEET 1 OF 1					