

NOTES:
 1 ALL DIMENSIONS SHOWN ARE FINISH OPERATIONAL DIMENSIONS WHICH INCLUDE RESIDUAL COATINGS UNLESS OTHERWISE SPECIFIED.

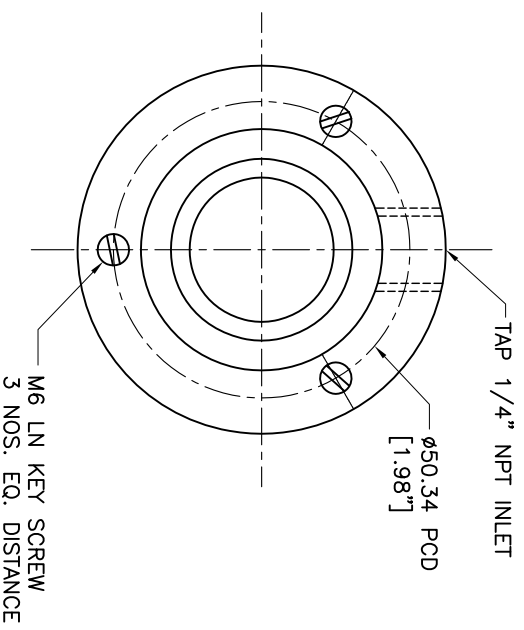
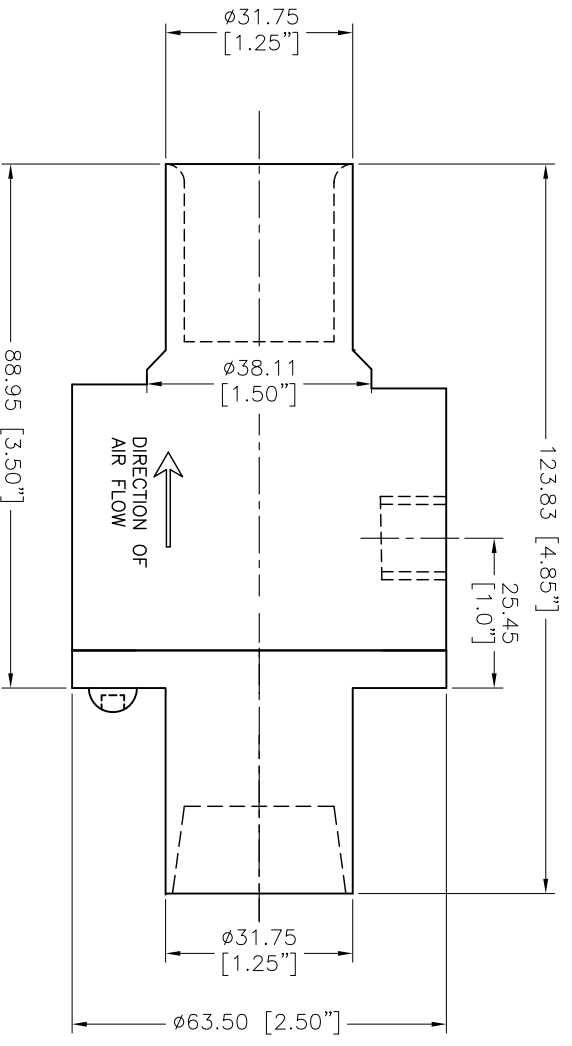

| REV | DESCRIPTION | DATE | APPROVED |
|-----|-------------------------|----------|----------|
| 1 | RELEASED FOR PRODUCTION | 08-07-26 | LR |

| | | | | | |
|---|--|--|--|--|--|
| REQUIREMENTS-UNLESS OTHERWISE SPECIFIED GENERAL 1. DIMS ARE IN INCHES (MM) 2. DIMENSIONING AND TOLERANCING IN ACCORDANCE WITH ANSI Y14.5 (1982) 3. MACHINE FINISH 125 MICRO INCH RMS 4. INTERNAL RADI .015 MICRO INCH RMS 5. BREAK SHARP CORNERS .005 TO .015 | | CONTRACT NUMBER - CLIENT - CONTRACTOR - | | DATE 10/06/2013 | |
| LIMITS 1. LINEAR DIMS. XXX = .005 XX = .010 X = .030 2. ANGLES = ± 1/2° 3. ROUNDOUT .010 MIN 4. HOLES IN ACCORDANCE WITH AND 10.97 | | PROJECT PROJECT - D.C. | | MANUFACTURING DATE NO. 30002S | |
| FINISH S.S. 304 | | DESIGN DESIGN - LES | | MATERIALS MATERIALS - C | |
| THIRD ANGLE PROJECTION | | SCALE 1:1 | | RELEASE / REV P / - | |
| TITLE NEX FLOW AIR PRODUCTS CORP. 10520 YONCE STREET, UNIT 399-220, RICHMOND HILL, ON L4C 3C7 TEL: (416) 410-1513 & FAX: (416) 410-1608 WWW.NEX-FLOW.COM | | SIZE C | | SHEET 1 OF 1 | |
| MATERIAL S.S. 304 | | PROJECT PROJECT - D.C. | | SCALE 1:1 | |

OUTLINE DRAWING OF
 1.25" S.S.304 RING VAC